

These drawings and specifications are the property of CAMBRIDGE TECHNOLOGY and shall not be reproduced, or copied, or used as the basis for the manufacture, or sale of apparatus without the written permission of CAMBRIDGE TECHNOLOGY, INC.

REVISION				
ECO	REV	DESCRIPTION	APPR	DATE
680	B	CONN. VIEW CORRECTED	PTH	12/94
-	C	.64 WAS .799, .799 WAS INCORRECT	PTH	2/95
-	D	AGC INPUT WAS 'OUTPUT'	PTH	3/95
869	E	OUTPUT SHAFT TOL. WAS $\pm \frac{.000}{.001}$	PTH	9/96
941	F	$\phi .865 / \phi .864$ WAS $\phi .866 / \phi .865$	PTH	1/97
	G	1.917 DIM ADDED	PTH	1/99
	G,	DIMS WERE IN INCHES	PTH	2/01

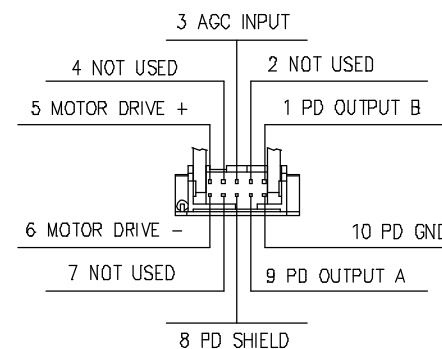
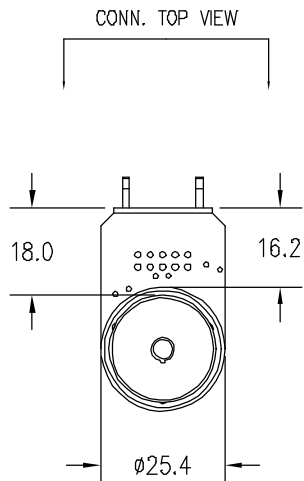
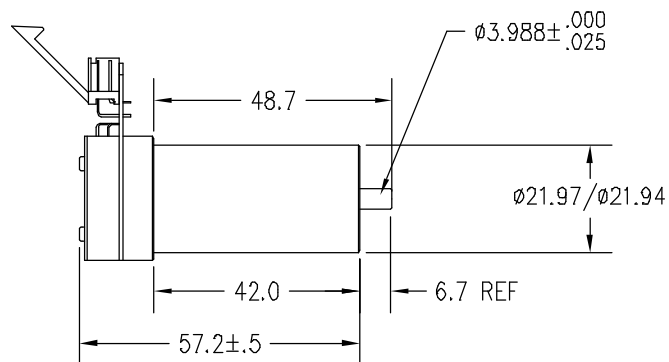

MASS = 145g

TOL.
 .x = ±.3
 .xx = ±.13
 (ALL DIMENSIONS ARE IN MM)

UNLESS OTHERWISE SPECIFIED TOLERANCES .XX±.010 .XXX±.005 () INDICATES mm ANGLES± 0°-30'	DRN	9/6/94	PTH	CAMBRIDGE TECHNOLOGY, INC. 109 SMITH PLACE CAMBRIDGE, MA. 02138 - USA
	DES			
MATERIAL	CHK			6850P OUTLINE DWG
	ENG			
FINISH	APPR			D02457
	PROJECTION			
USED ON	REVISION	G ₁		SCALE : NONE
				SHEET 1 OF 1